

EBDMR | Mid range, flush mounted detectors



Part of our mid-range, ceiling, flush mounted detectors. A superior detection pattern using a high performance faceted lens suitable for use in open spaces or where a larger detection range is required.

Key Product Features:

- Mid-range lens with concentric lens facets for improved detection
- 360° presence and absence detection
- Ideal for open spaces
- IP40 rated
- Available in a wide range of RAL colours.

Detection patterns

high < sensitivity > low

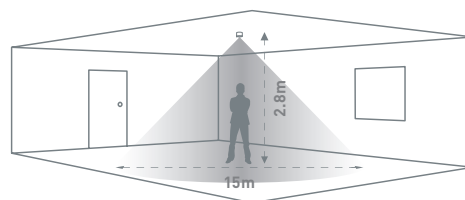



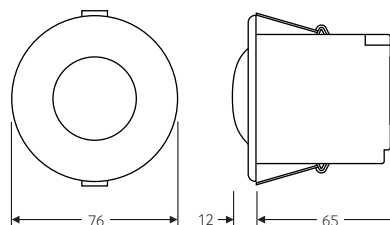



Dimensions (mm)



Technical Data

Part Code	EBDMR-PRM	EBDMR-DD	EBDMR-AD
Technical Data			
Control method	PRM Switching	DALI/DSI Digital Dimming	1–10V Analogue Dimming
IP rating	IP40	IP40	IP40
Device/ballast control	–	Up to 30 Drivers / Ballasts	Up to 10 Drivers / Ballasts
Weight	0.10kg	0.11kg	0.11kg
Supply voltage AC	230VAC+/-10%	120 or 230VAC+/-10%	120 or 230VAC+/-10%
Supply Frequency (Hz)	50Hz	50/60Hz	50/60Hz
Power consumption parasitic mW	840mW	810mW	724mW
Terminal capacity	2.5mm ²	2.5mm ²	
Working temperature range °C	-10 to 35	-10 to 35	-10 to 35
Humidity	5 to 95% non-condensing	5 to 95% non-condensing	5 to 95% non-condensing
Material (casing)	Flame retardant ABS and PC/ABS	Flame retardant ABS and PC/ABS	
Insulation class	Class 2	Class 2	Class 2
Compliance	EMC-2014/30/EU LVD-2014/35/EU	EMC-2014/30/EU LVD-2014/35/EU	EMC-2014/30/EU LVD-2014/35/EU
Time out range	10s–99m	10s–99m	10s–99m
Maximum loads			
Incandescent lighting (INC)	10A	10A	10A
Fluorescent lighting (F)	10A	10A	10A
Compact fluorescent lighting (CF)	10A	10A	10A
LED lighting (LED)	10A	10A	10A
Resistive heaters (RH)	10A	10A	10A

	<p>CP Electronics A Business unit of Legrand Electric Limited, Brent Crescent, London NW10 7XR, UK t. +44 (0)333 900 0671 info@cpelectronics.co.uk</p>	<p>Important notice:</p> <p>This device should be installed by a qualified electrician in accordance with the latest edition of the IEE Wiring Regulations and the applicable Building Regulations.</p> <p>Due to our policy of continual product improvement CP Electronics reserves the right to alter the specification of this product without prior notice.</p>	<div><p>BSI ISO 9001 Quality Management EN 43700</p><p>ISO 14001 Environmental Management EN 15400</p><p>OHSAS 18001 Occupational Health and Safety Management EN 15343</p></div> <div></div>
<p>www.cpelectronics.co.uk</p>	<p>connect with us</p> <div></div>		